

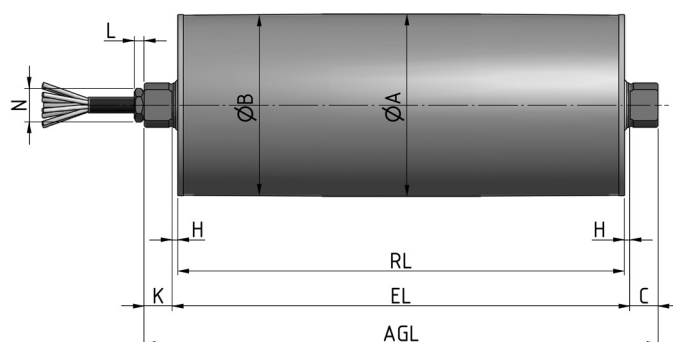

Motorized Pulley 80LS

A very compact strong drive for small high use conveyors



Standard Motorized Pulley with straight connector in stainless steel.

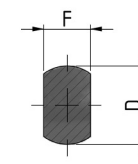

Shaft Cap.

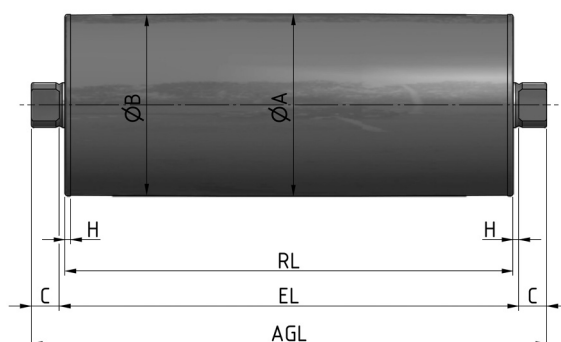

Idler Pulley, stainless steel version (TS).

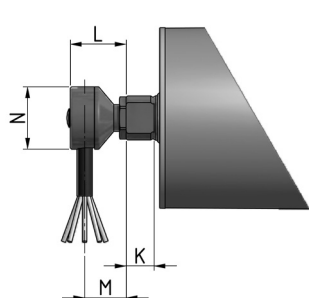

Elbow Connector in stainless steel.

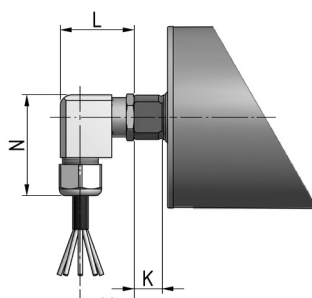

Elbow Connector in Polyamide.

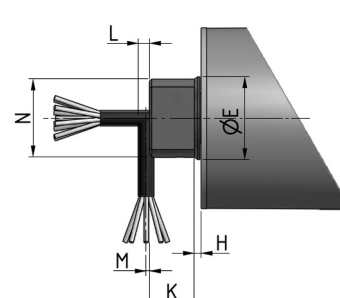

Straight/Elbow Connector with shaft cap in stainless steel.

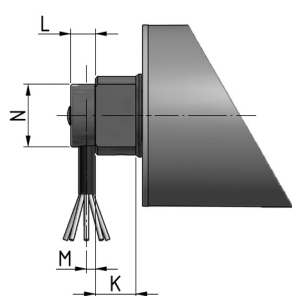

Elbow connector with shaft cap in stainless steel.

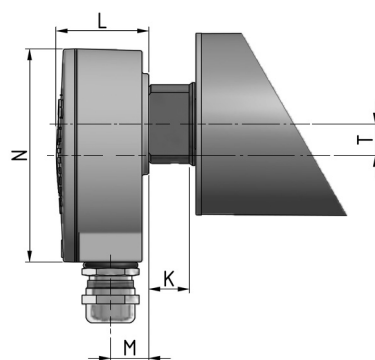

Terminal Box in Aluminium.

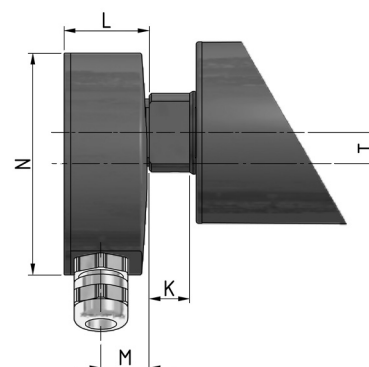

Terminal Box in Stainless Steel.



Motorized Pulley 80LS

A very compact strong drive for small high use conveyors

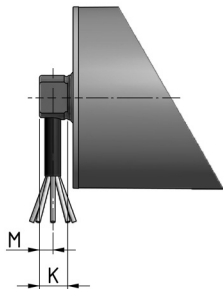

Cable Connector 90° with threaded shaft.

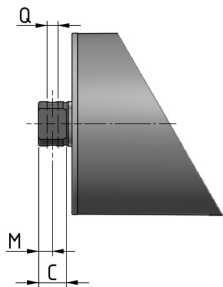

Cross-drilled and threaded shaft.

Type/Option	A mm	B mm	C mm	D mm	E mm	F mm	G mm	H mm	K mm	L mm	M mm	N mm	Q mm	T mm
Motorized pulley 80LS Standard version														
Straight connector in stainless steel	81,5	80,5	12,5	20		14		2,5	12,5	4,5		15		
Elbow connector in stainless steel									12,5	25	18,5	28		
Elbow connector in Polyamide									12,5	33	24	45		
Cable Connector 90° with threaded shaft									12,5		6			
Cross-drilled and threaded shaft									12,5		6,25		M6	
Straight/Elbow Connector with shaft cap in Stainless Steel			20	35	37	21		3	20	5	1,5	35		
Elbow Connector with shaft cap in Stainless Steel									18	11	4	28		
Terminal Box in Aluminium									18	41	17	95		14
Terminal Box in Stainless steel									18	38	21,5	99		14

